

DWG. NO.:	ISSUE DATE:
A-I	OCT 07, 2021
BLDG. CODE	SCALE:
FH	NTS
	DESIGN BY:
	PLL
	CHECKED BY:
	JXA

**RECORD FLOOR PLAN
FULTON HALL**

PROJECT NAME:
FIRST FLOOR PLAN

SALISBURY UNIVERSITY
FACILITIES PLANNING & CAPITAL PROJECTS
ARCHITECTURAL AND ENGINEERING SERVICES
1101 CAMDEN AVENUE
SALISBURY, MARYLAND 21801
410 - 543 - 6215

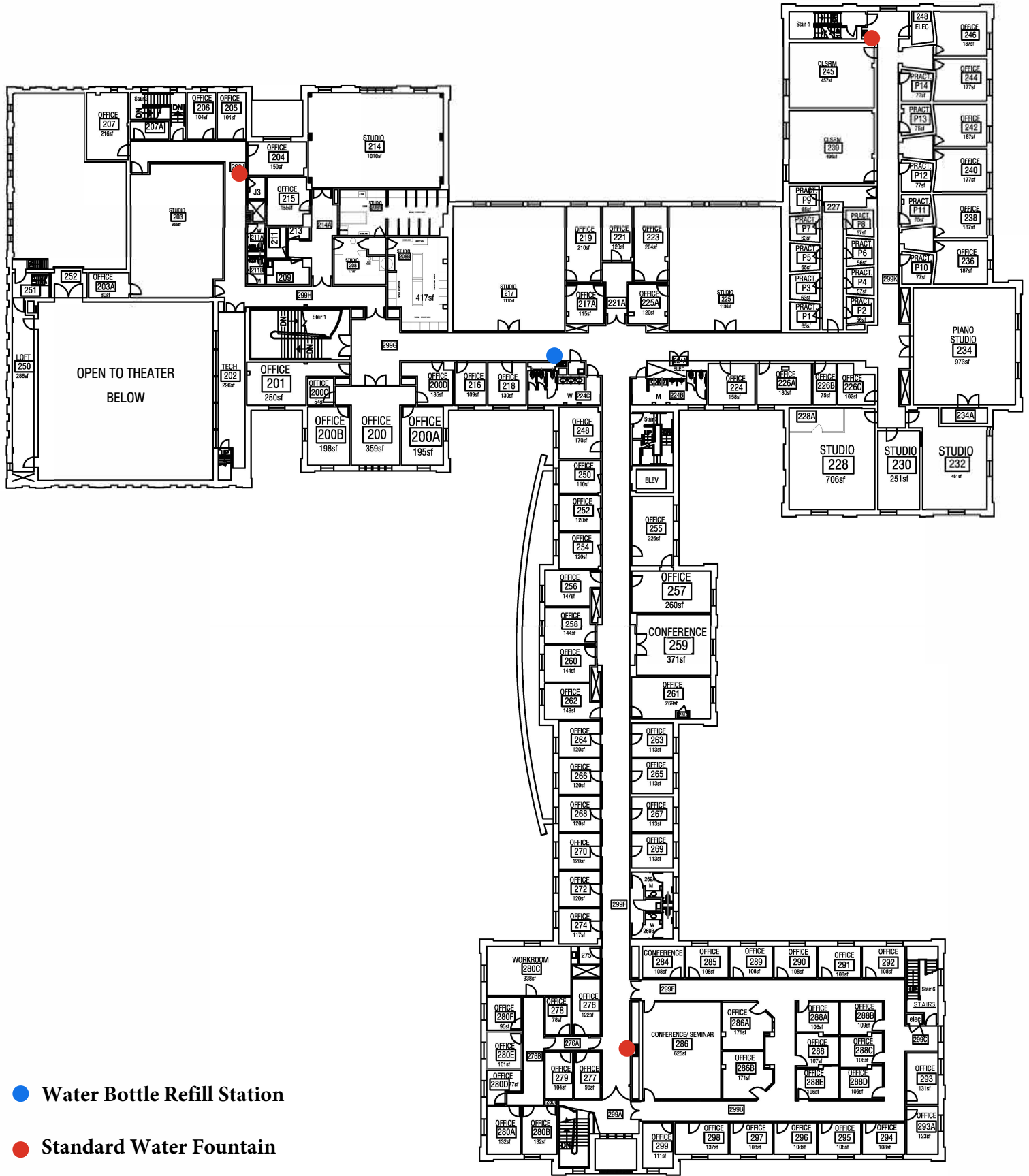

- Water Bottle Refill Station
- Standard Water Fountain

DWG. NO.:	ISSUE DATE:	RECORD FLOOR PLAN FULTON HALL	SECOND FLOOR PLAN	SALISBURY UNIVERSITY FACILITIES PLANNING & CAPITAL PROJECTS ARCHITECTURAL AND ENGINEERING SERVICES 1101 CAMDEN AVENUE SALISBURY, MARYLAND 21801 410 - 543 - 6215
A-2	SEPT. 19, 2022			
BLDG. CODE	SCALE:			
FH	NTS			
	DESIGN BY:			
	PLA			
	CHECKED BY:			
	JCD			